

Battery Operated Mobile Watering Cart

INSTRUCTIONS



Part No.
CRT-E209



Part No.
CRT-E208



Part No.
PS-600



Part No.
CRT-E210

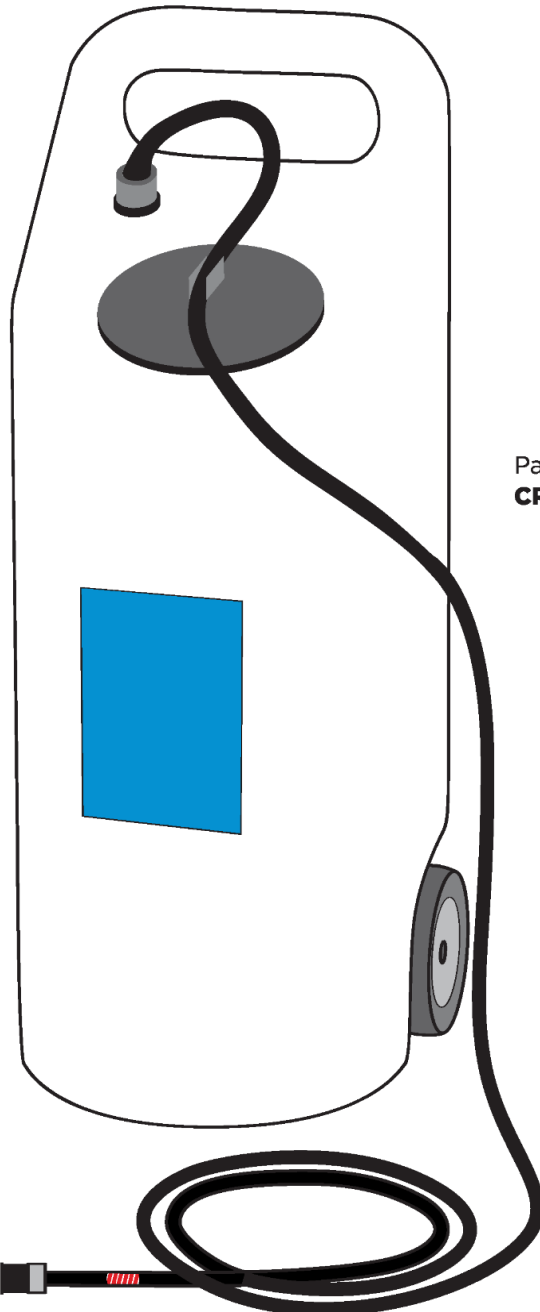

Part No.
CRT-3



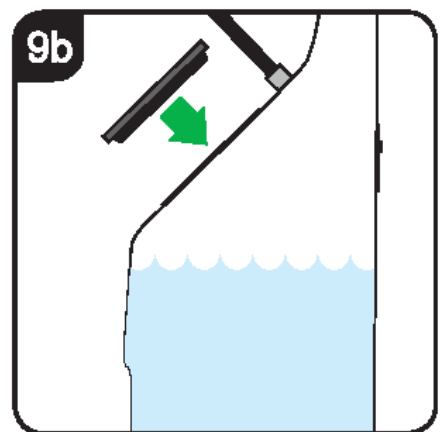
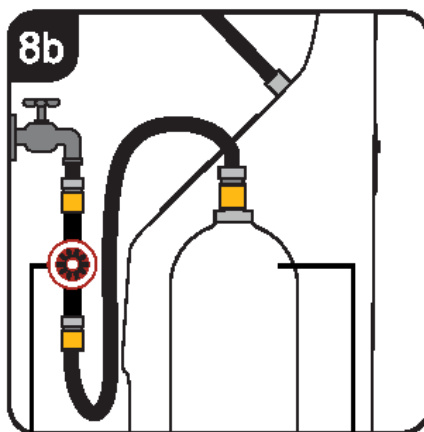
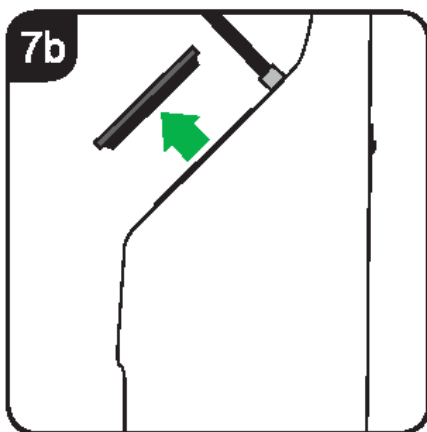
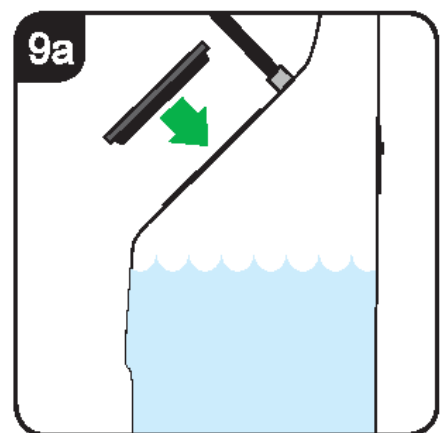
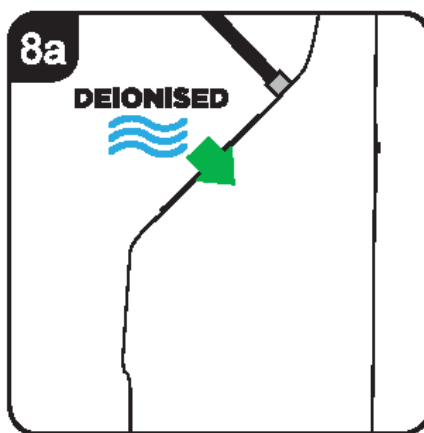
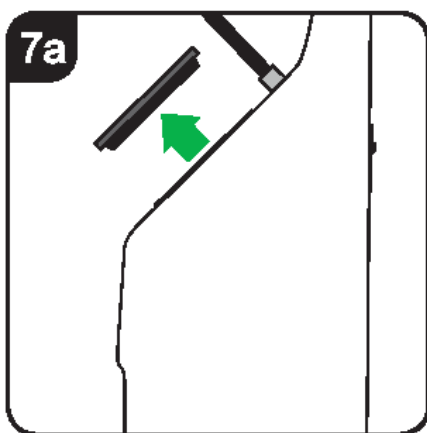
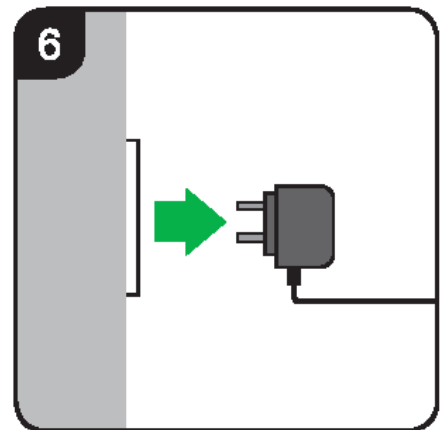
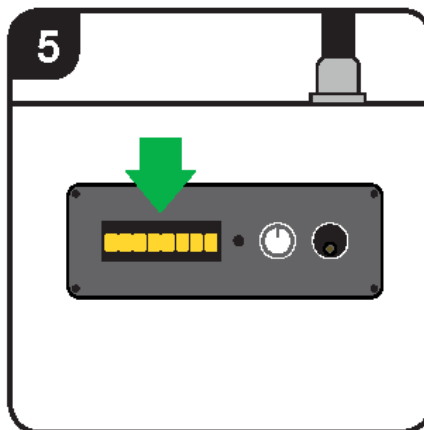
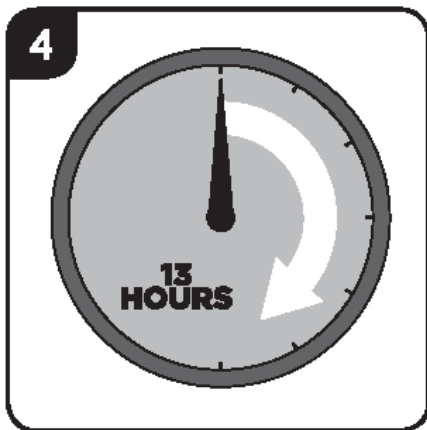
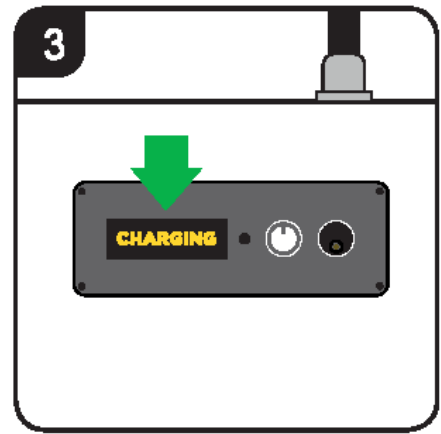
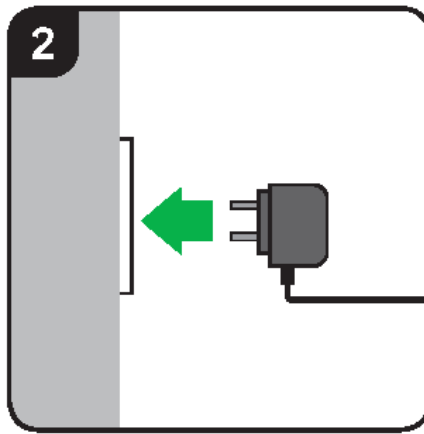
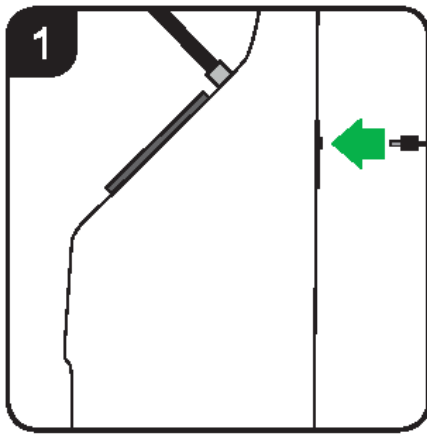

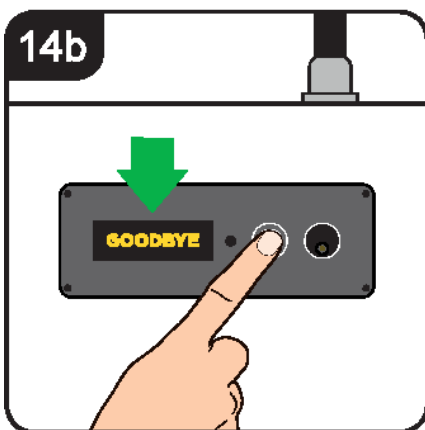
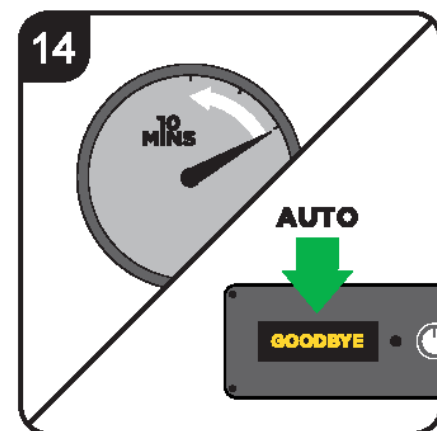
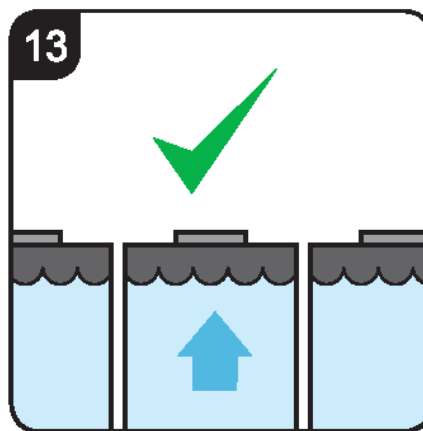
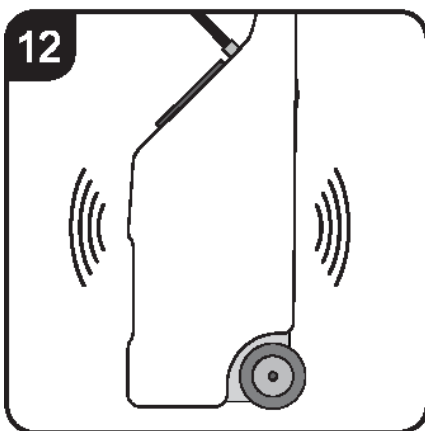
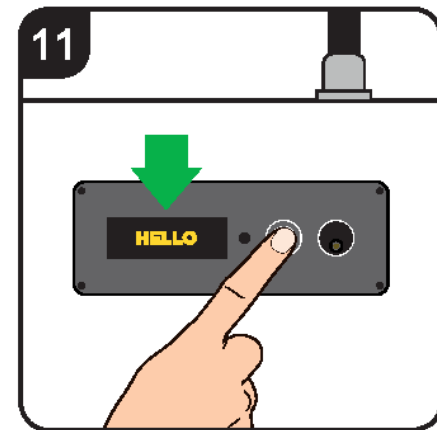
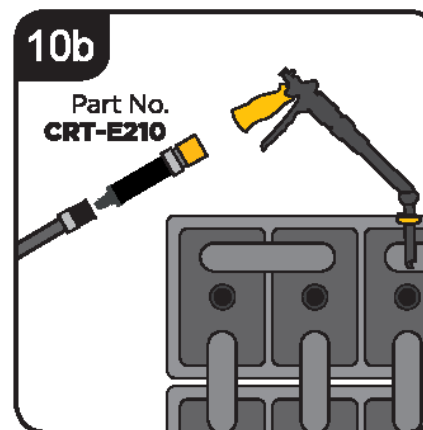
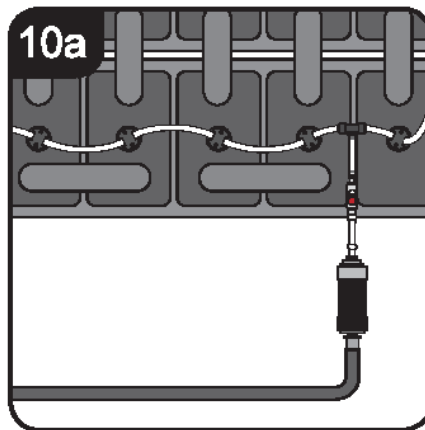
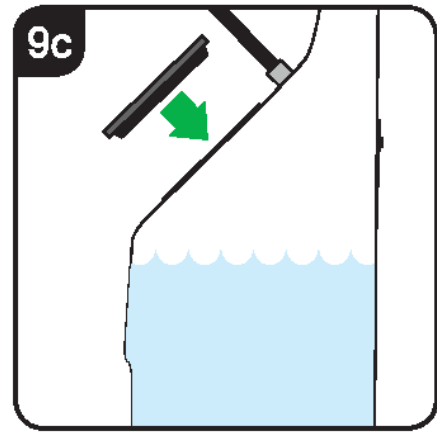
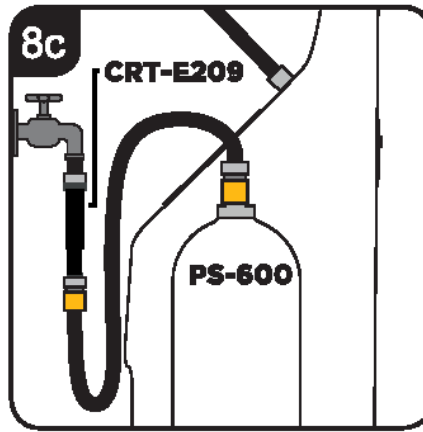
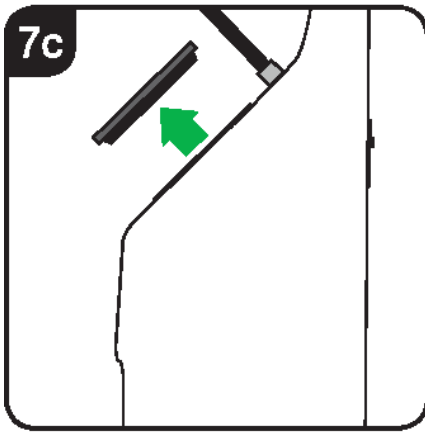

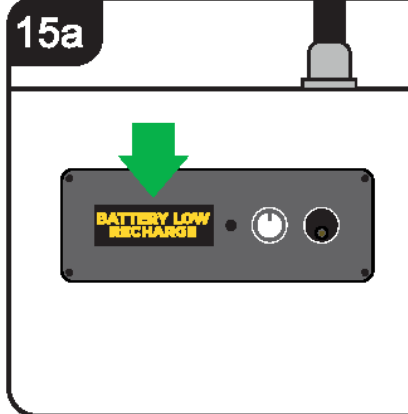
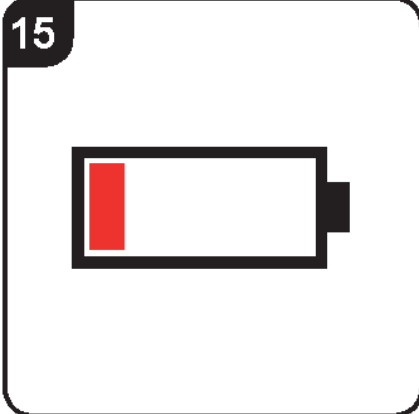

EN • BATTERY LOW
FR • BATTERIE FAIBLE
DE • BATTERIE LEER
ES • BATERIA BAJA
IT • BATTERIA SCARICA
NL • BATTERIJ BIJNA LEEG
PL • BATERIA ROZŁADOWANA

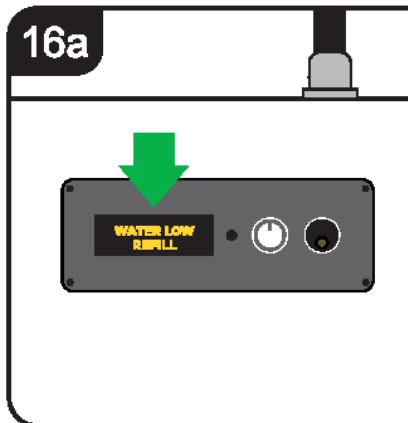
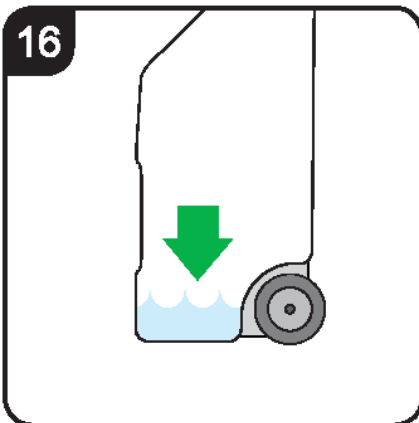

EN • WATER LOW
FR • EAU BASSE
DE • WASSER
ES • AGUA BAJA
IT • AQUA
NL • WATERNIVEAU LAAG
PL • NISKI POZIOM WODY

EN • REFILL
FR • REMPLIR
DE • AUFFUELLEN
ES • RELLENAR
IT • RABBOCCARE
NL • BIJVULLEN
PL • UZUPELNIJ

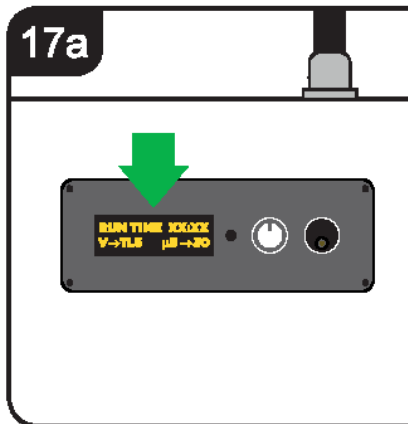
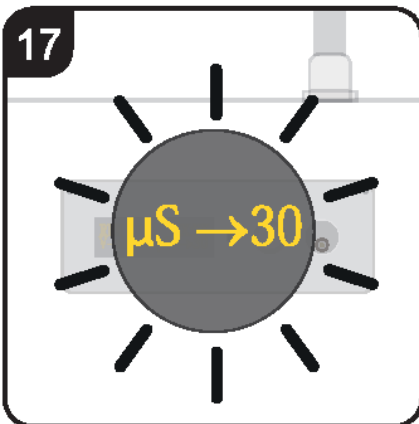

EN • PURITY X
FR • PURETE X
DE • REINHEIT X
ES • PUREZA BAJA
IT • PULIZIA X
NL • ZUIVERHEID X
PL • WYMIEN WKŁAD

● $\mu\text{S} \rightarrow \text{OK}$
● $\mu\text{S} \rightarrow 30$

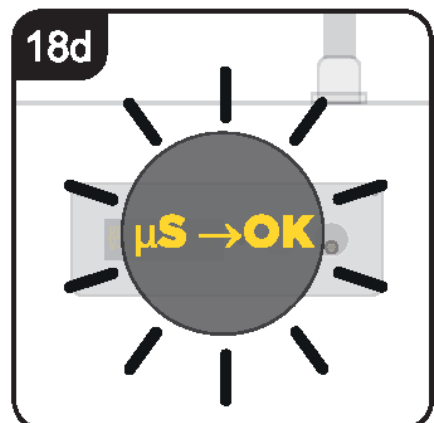
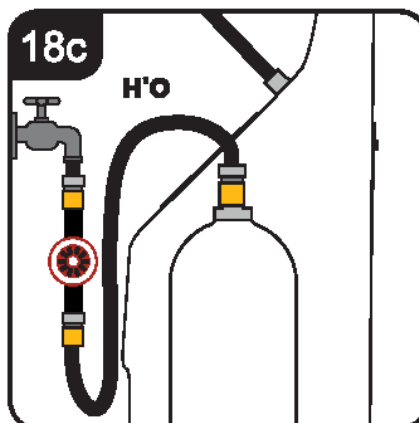
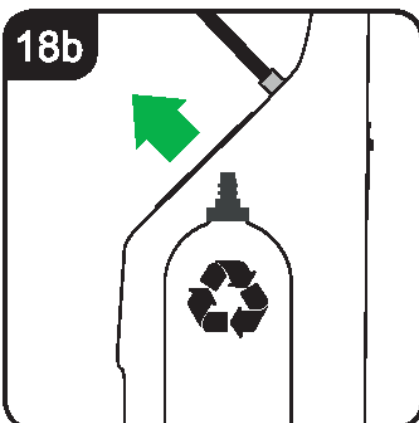

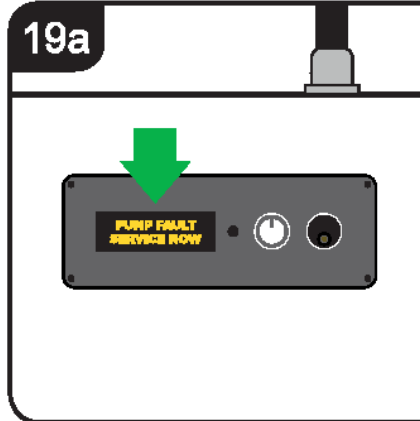
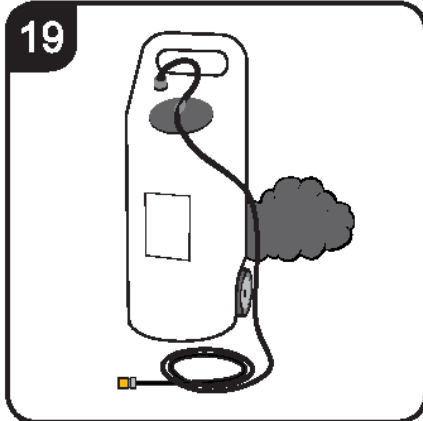

EN • PUMP FAULT
FR • PANNE DE POMPE
DE • FEHLER PUMPE
ES • FALLO DE BOMBA
IT • GUASTO POMPA
NL • POMP FOUT
PL • AWARIA POMY

EN • SERVICE NOW
FR • BESOIN DE REVISION
DE • SERVICE!
ES • MANTENIMIENTO DEL EQUIPO
IT • SERVIZIO
NL • SERVICE NODIG
PL • SERWIS!

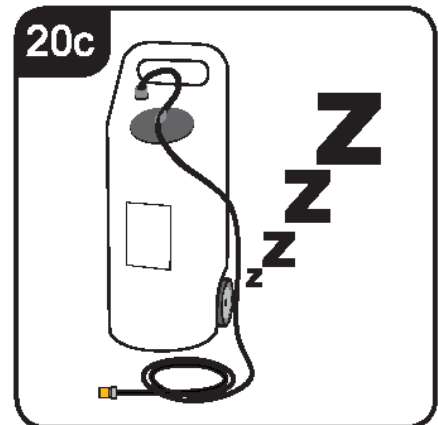
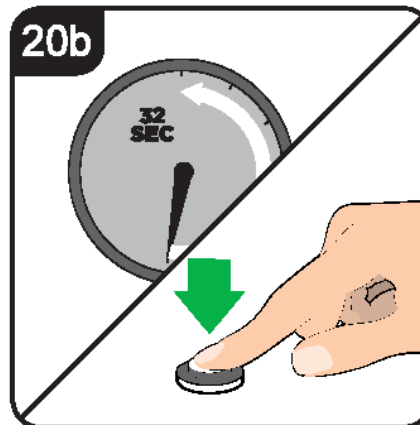
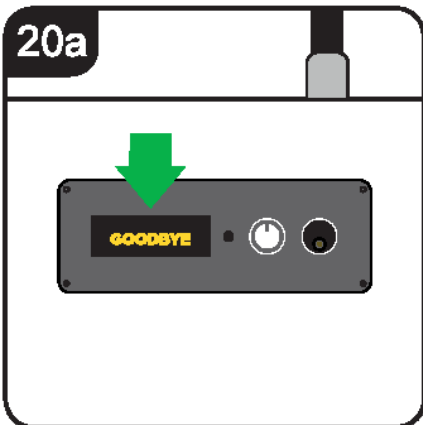

DIAGNOSTICS DIAGNOSTIQUES DIAGNOSE DIAGNOSTICO DIAGNOSI DIAGNOSE DIAGNOSTYKA

